

INDUSTRIAL FOR LEASE

AVAIL SF: 403,444

TOTAL BLDG SF: 403,444



ADDRESS 5959 RANDOLPH ST, COMMERCE CA ZIP 90040

Randolph Business Center
30' Clearance * ESFR * New Construction * Divisible
Large Fenced & Secured Yard * 165' Truck Access
Abundant Trailer Storage * Two Street Access
Excellent Access to (710) & (5) Freeways

LEASE RENTAL \$ 238,032 /mo Gross _____ Net 0.590 Term Acceptable To Owner
 SALE PRICE \$ NFS Price/SF \$ _____ Possession Immediate Tax \$ 371,895.00 Yr 2011-2012
 Avail SF 403,444 Power A 4000 V 277-480 Ø 3 W 4
 Min. SF 199,461 Heat NONE Cooling NONE PWR Notes VERIFY
 Land SF 684,214 Truck Hi Pos 59 Dim _____
 Const CTU Roof LAM Grd Lev Drs 2 Dim _____
 Rail NONE Unfin Ofc Mezz SF 0 Incl in Avail SF N Restrooms: _____
 Sprinklered ESFR Min Clear Height 30 OFFICE DATA Office SF 12,074 # TBD
 Pkg 233 Yard Yes-Fncd/Pvd Yr Blt 2009 A/C Y Heat Y Fin Ofc Mezz SF 5,937 Incl in Avail SF Y
 Thomas Bk Pg# 675-H1 Zone CMM2 To Show Call Broker - FOR APPOINTMENT Sp. Feat. FREE,PARK,YARD
 AGENT John McMillan, SIOR (213)955-6494, Jeff Sanita (213)955-5138, Region C Listing # 1244828
Tim Wallace (213)955-5108 FIRM Cushman & Wakefield 05/20/11
 FTCF CB250N125S150/AOAA Notes Vacant. Spkler: ESFR. Sp Ft: Free Standing Building, Paved Yard, Part of Industrial
Park. More trailer storage may be possible. 100% concrete truck court. 2.5% skylights. Access via Randolph St. & 61st St.,
www.randolphbusinesscenter.com.

THIS IS A LISTING OF THE "MULTIPLE" AND IS SUBJECT TO ALL ITS APPLICABLE RULES AND REGULATIONS

This information has been furnished from sources which we deem reliable, but for which we assume no liability. The information contained herein is given in confidence, with the understanding that all negotiations pertaining to this property be handled through the submitting office. All measurements are approximate.
 © American Industrial Real Estate Association



601 S. Figueroa Street, 47th Floor, Los Angeles, California 90017-5752 (213) 955-5100

RANDOLPH BUSINESS CENTER

403,444 SF

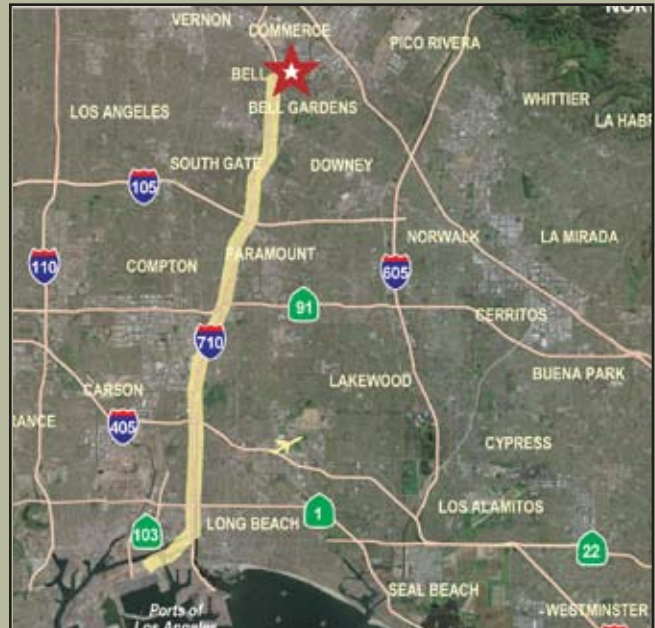
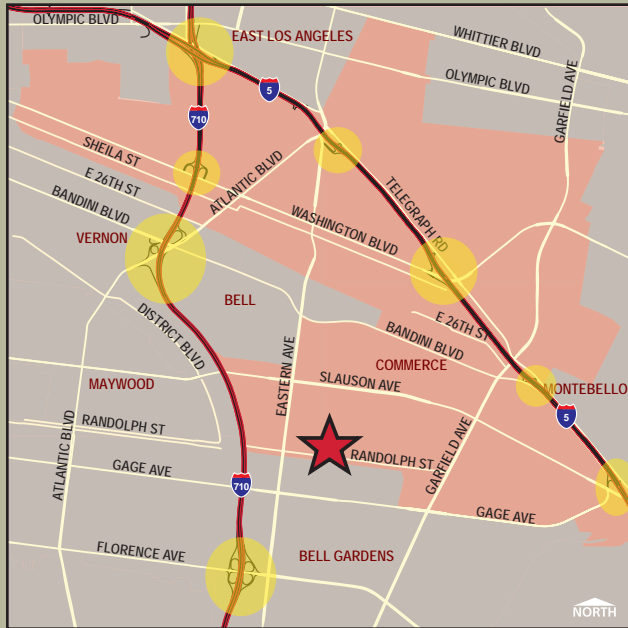
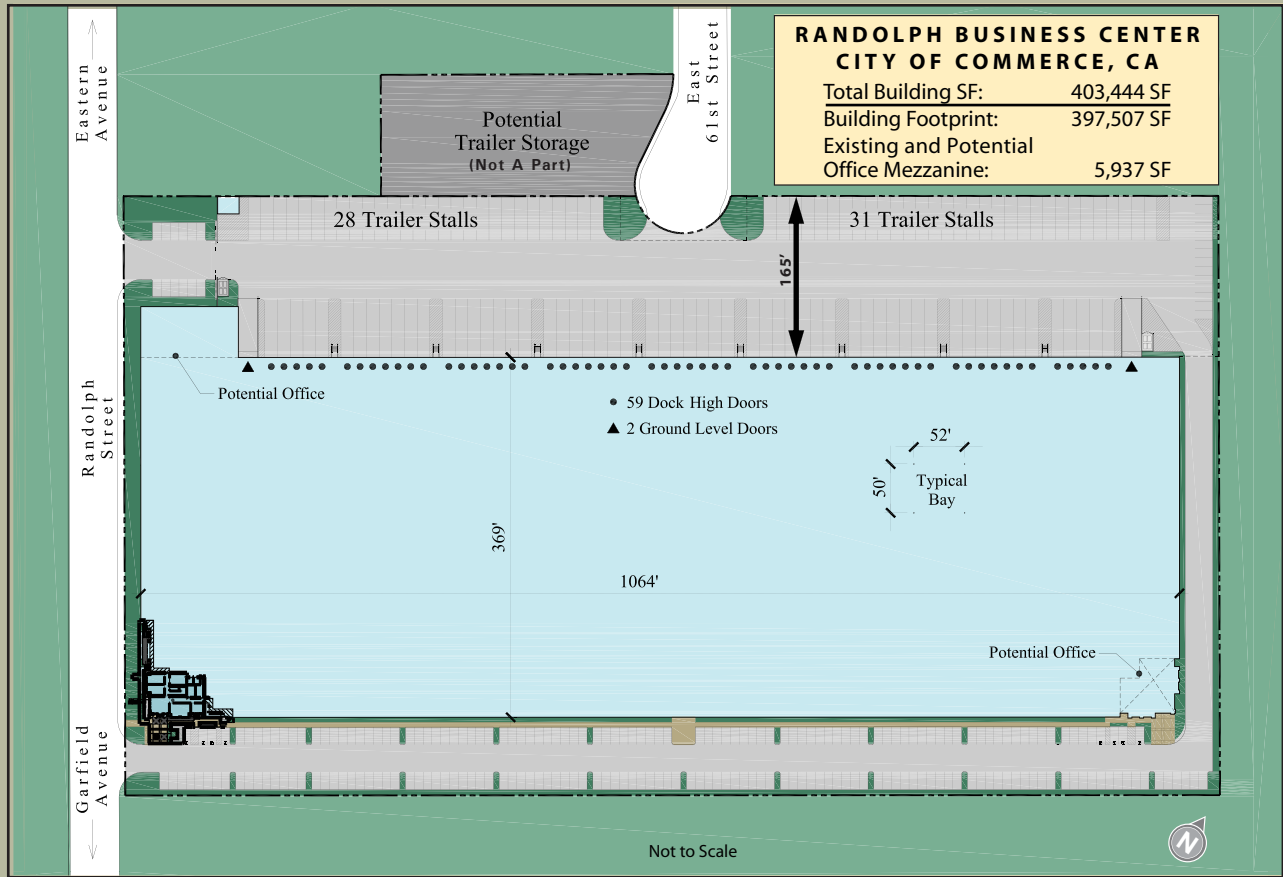

FOR FURTHER INFORMATION, PLEASE CONTACT:

John McMillan
john.mcmillan@cushwake.com
213.955.6494
Lic. #01103292

Jeff Sanita
jeff.sanita@cushwake.com
213.955.5138
Lic. #01242202

Tim Wallace
tim.wallace@cushwake.com
213.955.5108
Lic. #01779950

CUSHMAN & WAKEFIELD®
Global Real Estate SolutionsSM
601 South Figueroa Street, 47th Floor
Los Angeles, CA 90017
www.cushwake.com
License #00616335

No warranty or representation, expressed or implied, is made as to the accuracy of the information contained herein, and same is submitted subject to errors, omissions, change of terms, rental or other conditions, withdrawal without notice, and to any special listing conditions imposed by principals.